

DTC	C1789 / 89	L4 Position Switch Circuit
-----	------------	----------------------------

CIRCUIT DESCRIPTION

This circuit is sending the signal to the ECU by detecting that the transfer shift lever is in "L4" position.

DTC No.	DTC Detecting Condition	Trouble Area
C1789 / 89	L4 position switch signal does not change	<ul style="list-style-type: none">• L4 position switch• L4 position switch circuit• ECU

WIRING DIAGRAM

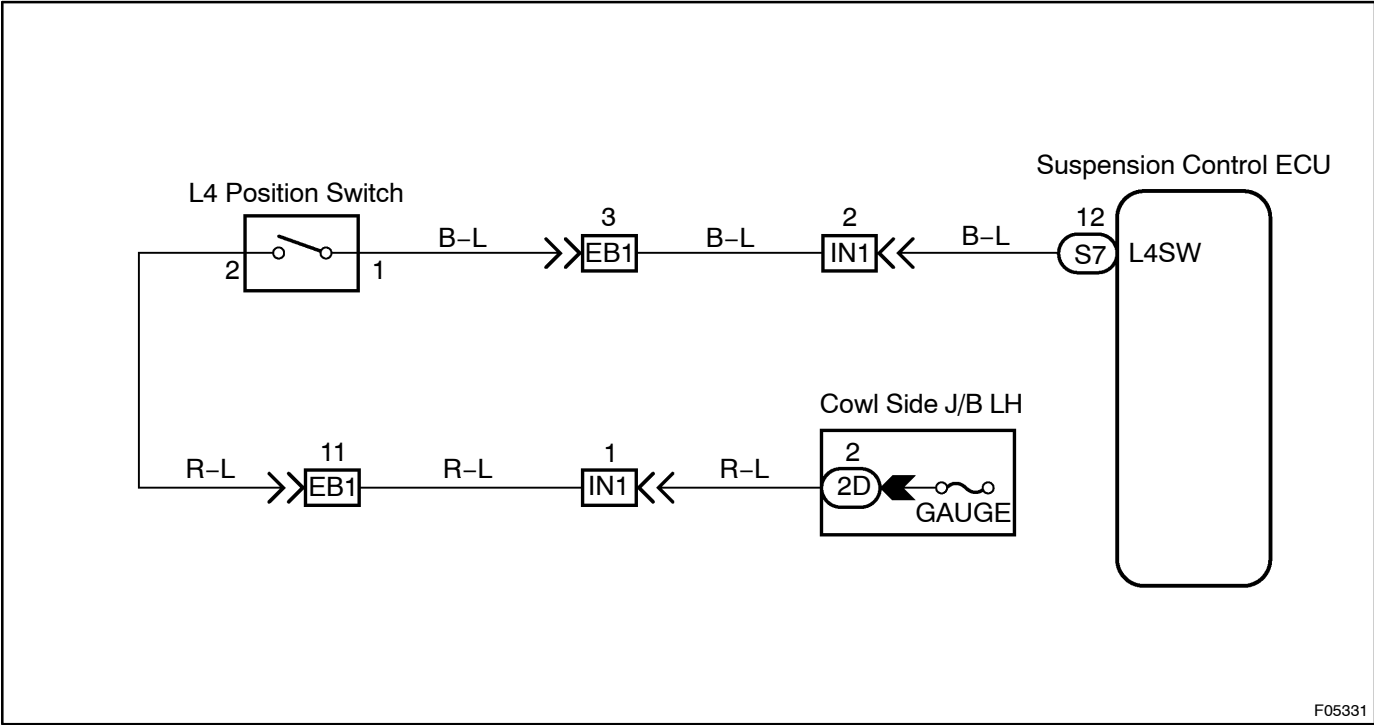

F05331

INSPECTION PROCEDURE

1	Check output signal of L4 position switch.
---	--

IN CASE OF USING LEXUS HAND-HELD TESTER:

PREPARATION:

- Connect the LEXUS hand-held tester to the DLC3.
- Turn the ignition switch ON and push the LEXUS hand-held tester main switch ON.
- Select the DATALIST mode on the LEXUS hand-held tester.

CHECK:

Check the L4 position switch condition displayed on the LEXUS hand-held tester when shifting the transfer shift lever in "L4" and "H4" positions.

OK:

When the transfer shift lever is shifted in "L4" position:

"ON" is displayed for L4 position switch condition.

When the transfer shift lever is shifted in "H4" position:

"OFF" is displayed for L4 position switch condition.

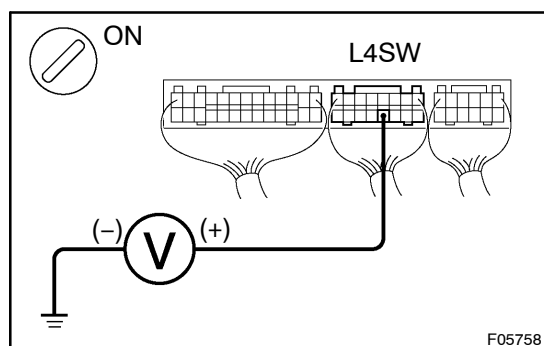

IN CASE OF NOT USING LEXUS HAND-HELD TESTER:

PREPARATION:

Remove the suspension control ECU with connectors still connected.

CHECK:

- Turn the ignition switch ON.
- Measure voltage between terminal L4SW of suspension control ECU connector and body ground when transfer shift lever is shifted in "L4" and "H4" position.

OK:

Transfer shift lever position	Voltage
L4	Below 1.5 V
H4	9 – 14 V

OK

No problem.

NG

2

Check L4 position switch.

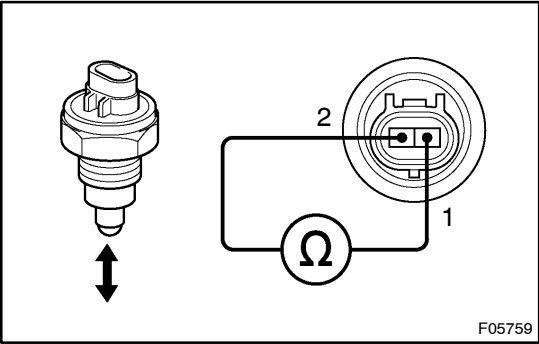

PREPARATION:

- (a) Disconnect the L4 position switch connector.
- (b) Remove the L4 position switch (See page [TR-7](#)).

CHECK:

Measure resistance between terminals 1 and 2 of L4 position switch connector when the L4 position switch pushed and released.

OK:

Switch condition	Resistance
Pushed	0 Ω (continuity)
Released	∞ Ω (Open)

NG

Replace L4 position switch.

OK

3

Check for open and short circuit in harness and connector between L4 position switch and suspension control ECU (See page [IN-33](#)).

NG

Repair or replace harness or connector.

OK

Check and replace suspension control ECU.